

# Product Information



**Preliminary Version**

## **SPC** **Single Power Connector**

## SPC – the new product line from ODU

The new product line SPC is a combination of the proven ODU lamella contacts and a robot housing of the push-pull connector lines ODU MINI-SNAP and ODU MINI-SNAP PC.

Housing of the product line  
ODU MINI-SNAP / MINI-SNAP PC

ODU Lamella Contact

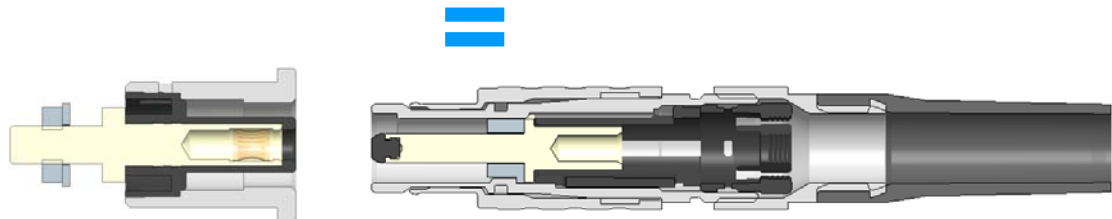

SPC (Single Pole Connector)

### Advantages of the new Connector:

- no accidental demating because of the push-pull locking
- high voltage contact with touch proof IP2X in unmated condition
- economical combination (single contact + housing)
  - robust housing
- high number of mating cycles > 5.000
- Economical processing because of crimp termination
- Contact diameter 3-18 mm (up to nominal current of 350 A)
- IP 50 or IP 67 in mated condition possible
- Für alle Kabeldurchmesser wie bei MINI-SNAP Serie
- Housing in the sizes 1-3 of the Push-Pull line
  - Housing size 4 and 6 with bayonet-locking
- nominal voltage up to 1.000 V

Application areas for this new connectors are: Industrial- and controlgear, power supply, emergency power supply, lightning technology, solar plants etc.

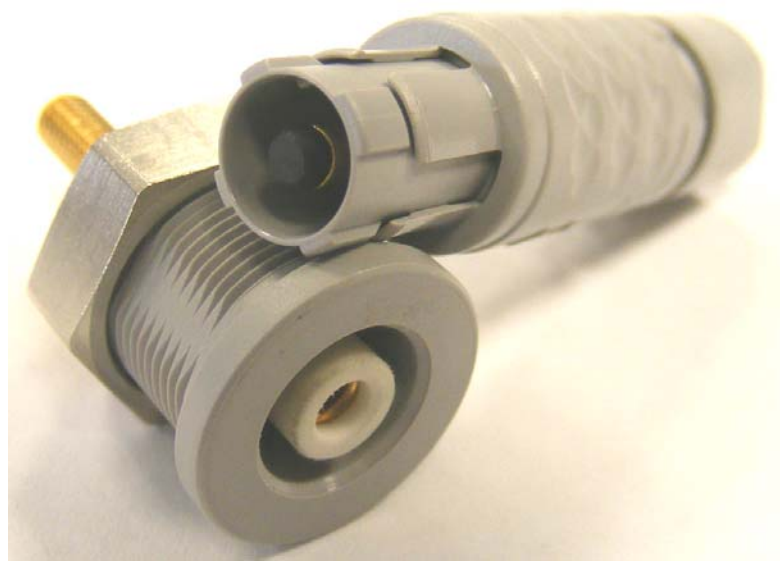

## **SPC Plastic housing with Push-Pull locking**

→ 3 Sizes

→ Color housing: Standard: grey and black

## Single Power Connector with Push-Pull Locking

### Plug

- Housing made out of plastic with Push-Pull locking
- Protection class IP 50 / IP 67 (in mated condition)
  - Touch proof IP2X (in unmated condition)
  - 3 coding possibilities

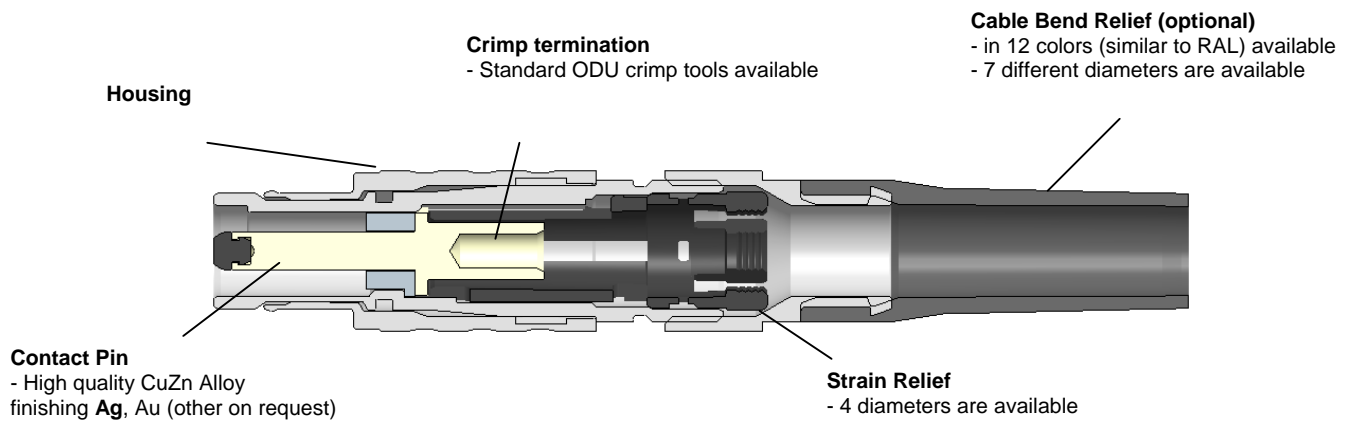

Size	∅ Contact Pin	Crimp termination* Standard termination	∅ Cable Bend relief	∅ Strain Relief
1	3 mm	4 mm <sup>2</sup>	2.5 – 0.7 mm	1.5 – 6.0 mm
2	4 mm	6mm <sup>2</sup>	3.0 – 9.0 mm	3.0 – 9.0 mm
3	5 mm	10 mm <sup>2</sup>	4.0 – 10.0 mm	4.5 – 10.5 mm

\* smaller cross section on request

## Single Power Connector with Push-Pull locking

### Receptacle

Housing made out of plastic Push-Pull locking

→ Protection class IP 50 / IP 67 (in mated condition)

→ Touch proof IP2X (in unmated condition)

→ 3 Coding possibilities

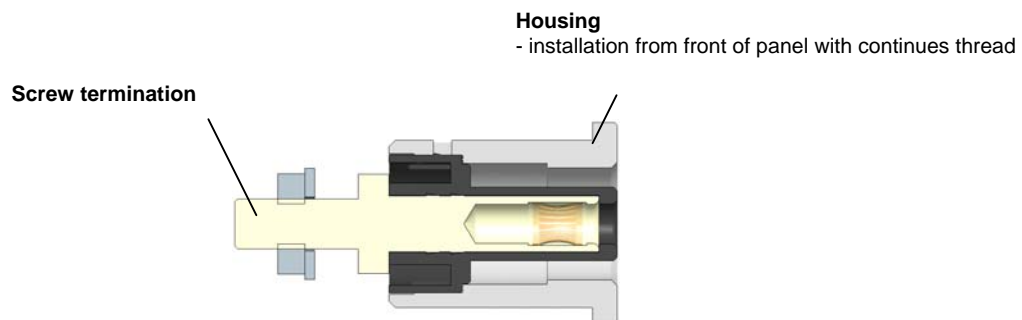
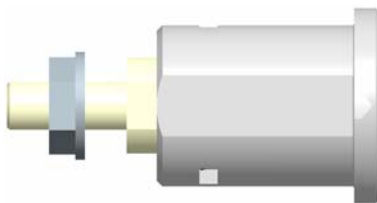

Size	∅ Contact socket	Nominal current A	max. continuous current A	Contact resistance $\mu\Omega$	Screw Termination Thread	length of bolt
1	3 mm	40	55	270	M4	ca. 10 mm
2	4 mm	60	80	220	M5	ca. 12 mm
3	5 mm	75	110	190	M6	ca. 14 mm

Smaller size of thread on request

## Single Power Connector with Push-Pull locking

### In-Line Receptacle

- Housing made out of plastic with Push-Pull locking
- Protection class: IP 50 / IP 67 (in mated condition)
  - Touch proof IP2X (in unmated condition)
  - 3 coding possibilities

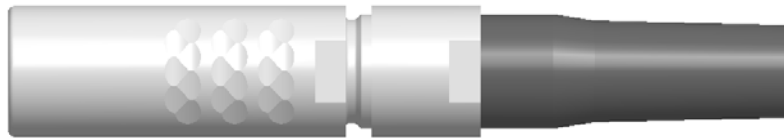

Contact Socket  
 Contact element: Lamella  
 Surface **Ag**, Au (other on request)  
 High current load capacity

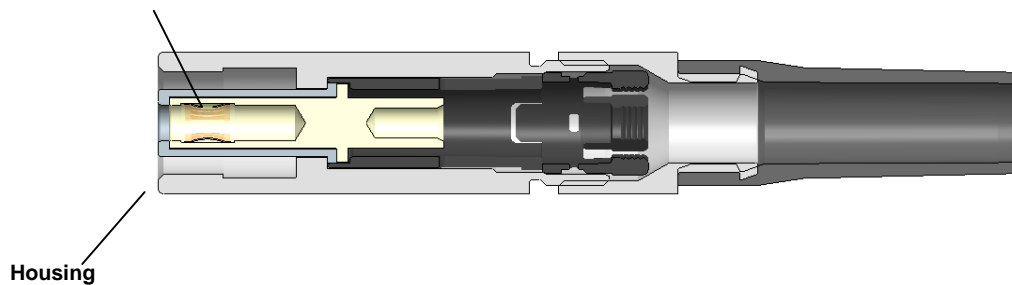

Size	∅ Contact socket	Nominal current A	max. continuous current A	Contact resistance $\mu\Omega$
1	3 mm	40	55	270
2	4 mm	60	80	220
3	5 mm	75	110	190



**SPC Metal housing  
with bayonet-locking**  
→ 2 Sizes

## Single Power Connector with bayonet-locking

### Plug

- Housing made out of metal with bayonet-locking
- Protection class IP 50 / IP 67 (in mated condition)
- Touch proof IP2X (in unmated condition)
- Coding on request

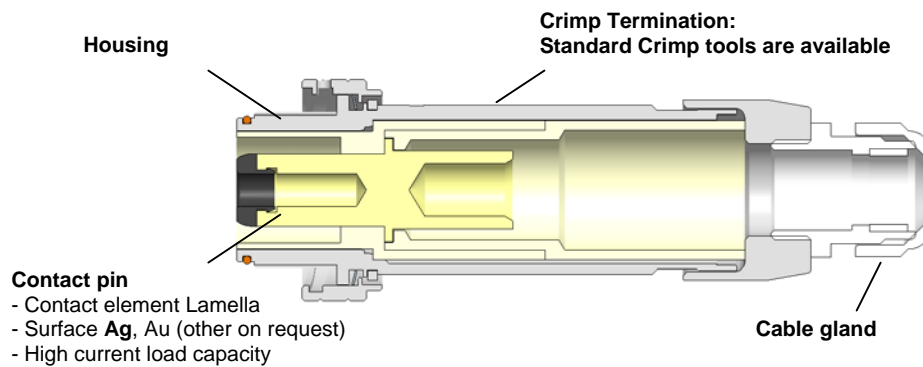

Size	∅ contact pin	Crimp termination* Standard termination	Cable gland*
4	8 mm	35 mm <sup>2</sup>	M16 x 1.5
6	18 mm	95 mm <sup>2</sup>	M16 x 1.5

\* other on request  
In-Line Receptacle on request

## Single Power Connector with bayonet-locking

### Receptacle

Housing made out of metal with bayonet-locking

→ Protection class IP 50 / IP 67 (in mated condition)

→ Touch proof IP2X (in unmated condition)

→ Coding on request

→ with crimp termination – screw termination on request

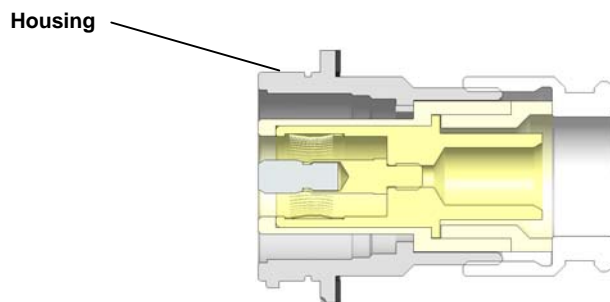

Size	Ø Contact socket	Nominal current A	max. continuous current A	Contact resistance $\mu\Omega$
4	8 mm	150	210	110
6	18 mm	350	500	120

In-Line Receptacle on request!



## SPC Plastic housing with snap-fit locking

→ 3 sizes

→ Color housing: Standard: grey and black

**only on request**

## Single Power Connector with snap-fit locking

### Plug

Housing made out of plastic with snap-fit locking

→ Protection class IP 50 (in mated condition)

→ Touch proof IP2X (in unmated condition)

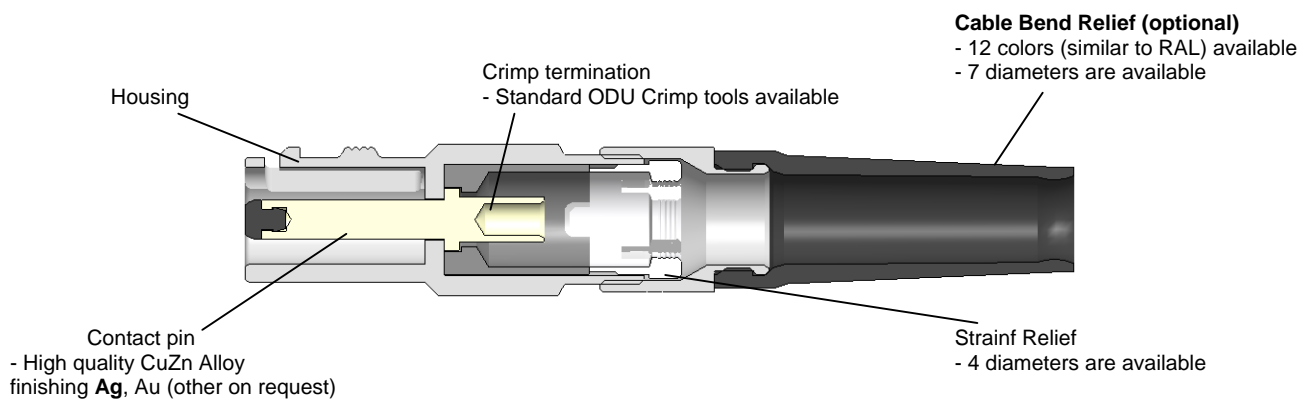
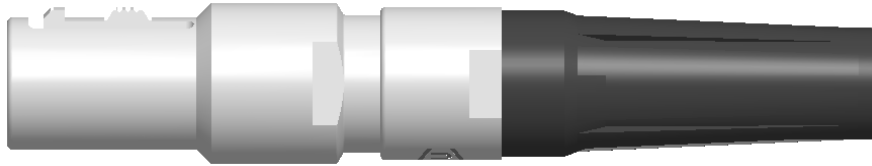

Size	∅ Contact Pin	Crimp termination* Standard termination	∅ Cable Bend Relief	∅ Strain Relief
1	3 mm	4 mm <sup>2</sup>	2.5 – 0.7 mm	1.5 – 6.0 mm
2	4 mm	6mm <sup>2</sup>	3.0 – 9.0 mm	3.0 – 9.0 mm
3	5 mm	10 mm <sup>2</sup>	4.0 – 10.0 mm	4.6 – 10.0 mm

\* smaller diameters on request

**only on request**

## Single Power Connector with snap-fit locking

### Receptacle

Housing made out of plastic with snap-fit locking

→ Protection class IP 50 (in mated condition)

→ Version for installation from front of panel and with continues thread

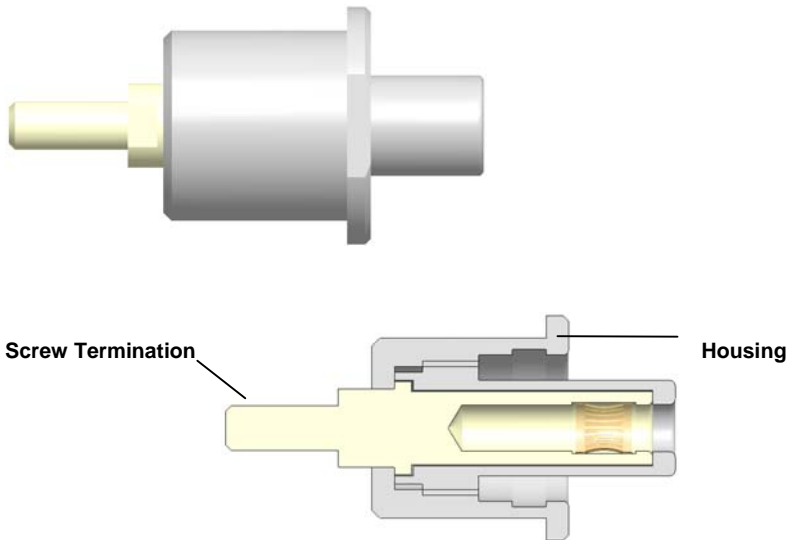

Size	∅ Contact socket	Nominal current A	max. continuous current A	Contact resistance $\mu\Omega$	Screw Termination Thread	length of bolt
1	3 mm	40	55	270	M4	ca. 10 mm
2	4 mm	60	80	220	M5	ca. 12 mm
3	5 mm	75	110	190	M6	ca. 14 mm

\* Smaller size of thread on request

**only on request**

## Single Power Connector with snap-fit locking

### In-Line Receptacle

Housing made out of plastic with snap-fit locking  
 → Protection class IP 50 (in mated condition)

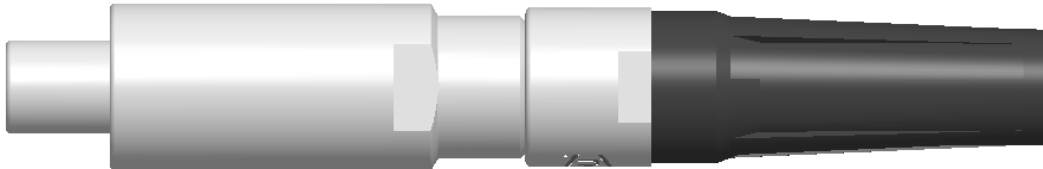

#### Contact socket

Contact element: Lamella  
 Surface **Ag**, Au (other on request)  
 High current load capacity

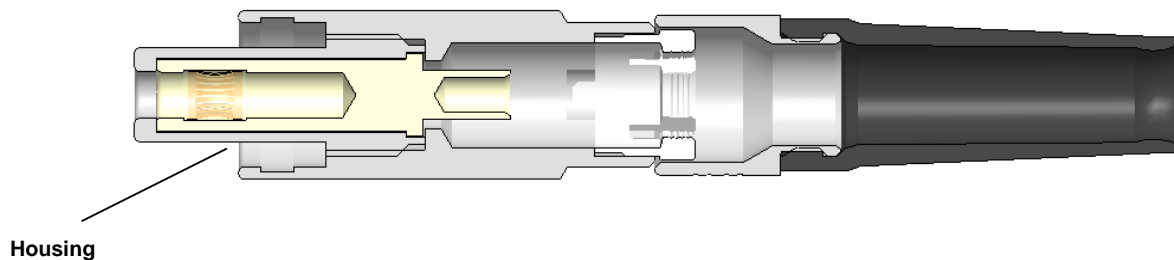

Size	∅ Contact socket	Nominal current A	Max. continuous current A	Contact resistance $\mu\Omega$
1	3 mm	40	55	270
2	4 mm	60	80	220
3	5 mm	75	110	190

**only on request**

**Further Information:**

**ODU Steckverbindungssysteme GmbH & Co. KG**

**Otto Dunkel GmbH**

**ODU Automotive GmbH**

Pregelstraße 11

D – 84453 Mühldorf am Inn

Phone: +49/8631/6156-0

Fax: +49/8631/6156-49

E-Mail: [zentral@odu.de](mailto:zentral@odu.de)

[www.odu.de](http://www.odu.de)

**ODU Worldwide**



**ODU France**

Phone.: +33/13935-4690

E-Mail: [odu@odu.fr](mailto:odu@odu.fr)

**ODU Scandinavia**

Phone.: +46/176/182 61

E-Mail: [peter.biloch@odu.se](mailto:peter.biloch@odu.se)

**ODU Shanghai**

Phone: +86/21/5834 7828-106

E-Mail: [chen.xin@odu.com.cn](mailto:chen.xin@odu.com.cn)

**ODU UK**

Phone.: +44/1509-266 433

E-Mail: [sales@odu-uk.co.uk](mailto:sales@odu-uk.co.uk)

**ODU USA**

Phone.: +1/805/484 0540

E-Mail: [joe.cisi@odu-usa.com](mailto:joe.cisi@odu-usa.com)